

## Ezekiel 40-48

- I. The Commission And Call Of Ezekiel (1:1-3:27)
  - A. Ezekiel Beholds The Glory Of God (1:1-28)
  - B. Ezekiel Is Commissioned To The Word Of God (2:1-3:27)
- II. Present Judgments On Jerusalem And Judah (4:1-24:27)
  - A. Four Signs Of Coming Judgment (4:1-5:17)
  - B. Two Messages Of Coming Judgment (6:1-7:27)
  - C. Four Prophecies Through Visions (8:1-11:25)
  - D. The Certainty Of Judgment With Their Causes Through Signs, Messages, And Parables (12:1-24:27)
- III. Prophecies Against Gentile Nations (25:1-32:32)
  - A. Against Ammon (25:1-7)
  - B. Against Moab (25:8-11)
  - C. Against Edom (25:12-14)
  - D. Against Philistia (25:15-17)
  - F. Against Sidon (28:20-24)
  - G. The Regathering Of Israel. (28:25-26)
  - H. Against Egypt (29:1-32:32)
- IV. Prophecies Of The Restoration Of Israel (33:1-48:35)
  - A. The Return Of Israel To The Land (33:1-39:29)
  - B. The Restoration Of Israel In The Kingdom (40:1-48:35)
    - 1. The Temple. 40:1-43:12

## Temple Size Comparisons

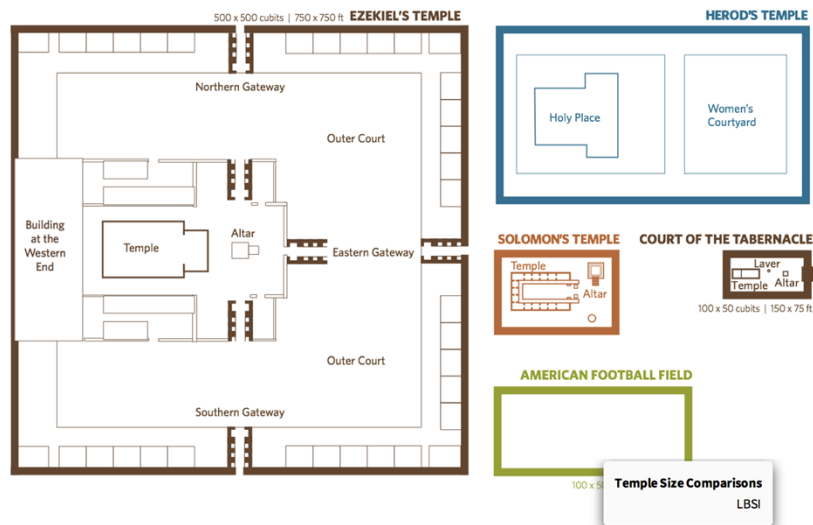

## Introduction<sup>1</sup>

1. Ezekiel's Temple is the centerpiece of Ezekiel's vision in Ezek 40–44.
2. Context: Eze 37:27-28
3. Difficulties and Resolutions
  - A. A memorial of the pre-captivity temple.
  - B. The post-exilic temple.
  - C. The idealized temple the Jews should have built.
  - D. A depiction of the heavenly state.
  5. A depiction of the present church age.
  6. An apocalyptic symbol of the messianic age.
  7. The temple that will be built in the messianic kingdom.
4. Ezekiel's Altar and Sacrifice
5. Ezekiel's Temple and the Canon

### Bibliography:

- Hullinger, Jerry M. "The Problem of Animal Sacrifices in Ezekiel 40–48." *Bibliotheca Sacra* 152 (July-September, 1995): 279–89.
- Schmitt, John and Laney. *Messiah's Coming Temple*. Grand Rapids: Kregel, 1997.
- Thompson, Clive A. "The Necessity of Blood Sacrifices in Ezekiel's Temple." *Bibliotheca Sacra* 123 (July 1966): 237–48.<sup>2</sup>

## Ezekiel 40:1-49

### a. The Man With The Measuring Rod. 40:1-4

- 1 In the twenty-fifth year of our exile (**GALUTH = 15x; 573-572 B.C.**), at the beginning of the year, on the tenth of the month (**Nisan 10**), in the fourteenth year after the city was taken (**587-86 – 14 yrs = 573-72 B.C.**), on that same day the hand of the LORD was upon me (**Ezekiel**) and He brought me there (**to the city**).
- 2 In the visions (**MA'RAH**) of God He brought me into the land of Israel, and set me (**Hiph IPF + w.c. NUACH**) on a very high mountain (**Mic 4:1; Isa 2:2**); and on it to the south there was a structure (**MIBANAH**) like a city.
- 3 So He (**the Lord**) brought me there; and behold, there was a man (**'ISH**) whose appearance was like the appearance of bronze (**cf Dan 10:4-5**), with a line of flax (**linen measuring cord; cf Eze 44:17-18**) and a measuring rod in his hand; and he (**the man**) was standing in the gateway.

---

<sup>1</sup> (Taken from: The Lexham Bible Dictionary, LOGOS software.)

<sup>2</sup> Laney, J. C. (2016). [Temple, Ezekiel's](#). In J. D. Barry, D. Bomar, D. R. Brown, R. Klippenstein, D. Mangum, C. Sinclair Wolcott, ... W. Widder (Eds.), *The Lexham Bible Dictionary*. Bellingham, WA: Lexham Press.

- 4 And the man said to me, "Son of man, see with your eyes, hear with your ears, and give attention to all that I am going to show you; for you have been brought here in order to show it to you. Declare to the house of Israel all that you see."

**Summary:**

1. **The detail given is designed to show the specificity of prophecy.**
2. **The mountain in question is raised up above all the other mountains in fulfillment of multiple prophecies. Mic 4:1-2; Isa 2:2-4**
3. **With the 7<sup>th</sup> Bowl judgment, all the mountains disappear, with this exception. Rev 16:20**
4. **This man resembled the one who appeared to Daniel. Dan 10:4-6**
5. **The Apostle John was given an assignment similar to this man to measure the Tribulational Temple. Rev 11:1-2**
6. **In context, this Temple does not need to be built until after the destruction of the King of the North, making it the Millennial Temple. Eze 38-39**